

NOTE:
REFER TO PLAN G-1 FOR THE LEGAL DESCRIPTION.

NOTE:
REFER TO PLAN G-7 FOR THE CENTERLINE LINE TABLES.

- LEGEND**
- = UPLAND BUFFER / CONSERVATION
 - = CONSERVATION
 - = WETLAND
 - = WETLAND IMPACT

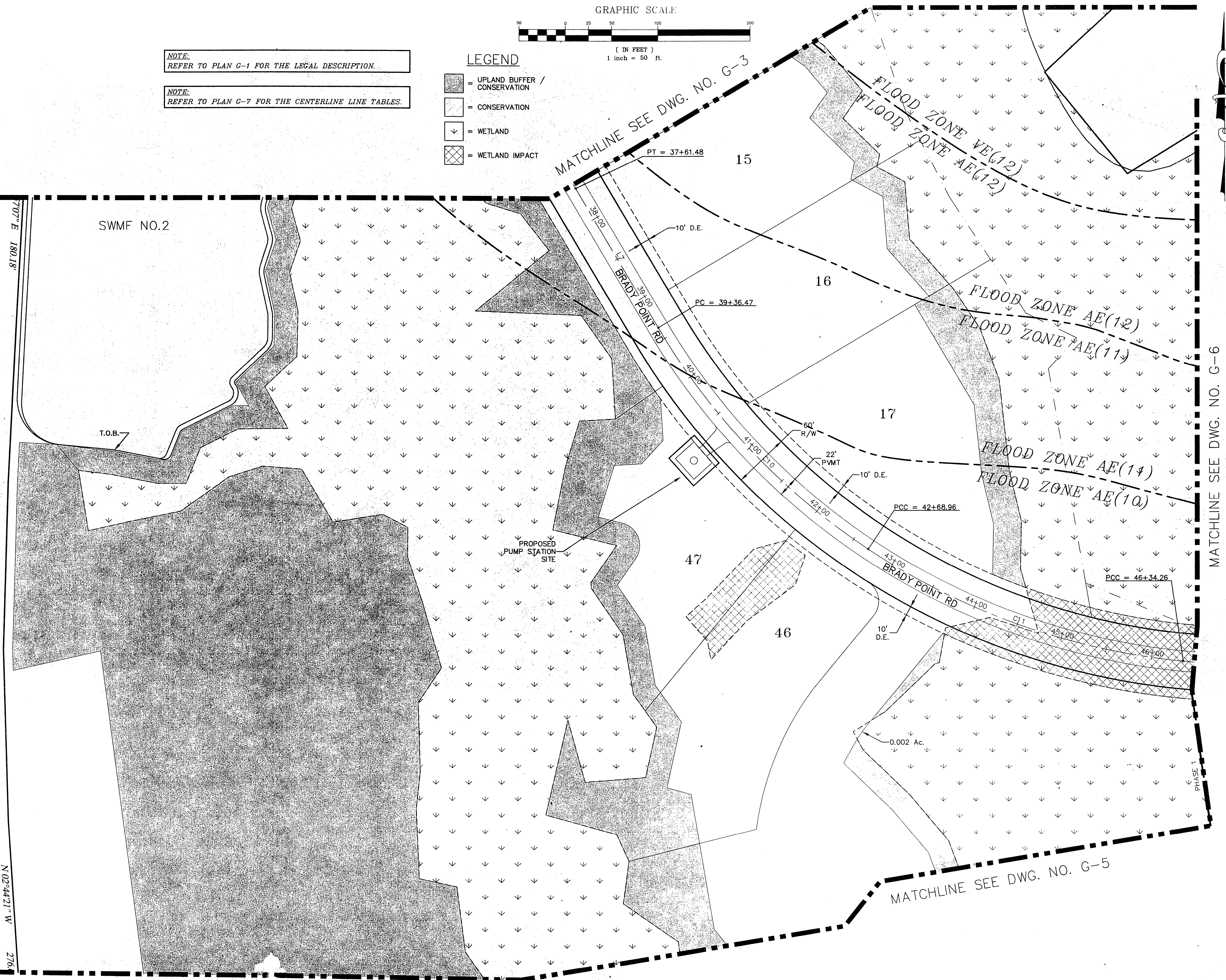
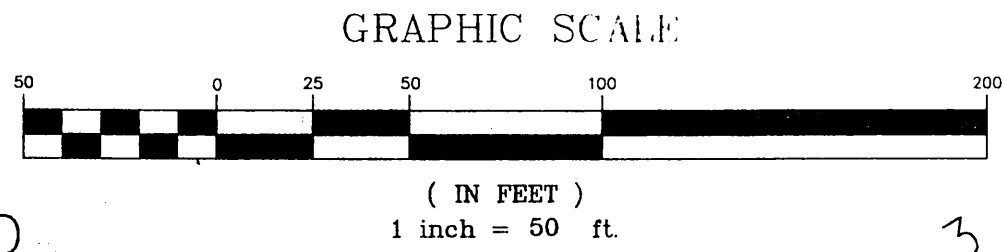

NO.	DATE	DESCRIPTION	BY
1	5/27/04	ENLARGE RD NAME	VJK

DESIGNED BY: PLB
 DRAWN BY: SS, SM, AK
 CHECKED BY: VJD
 SCALE: 1" = 50'
 DATE: JULY, 2003
 PROJ. NO.: 0205-280

VINCENT J. DUNN
 REGISTERED ENGINEER NO. 38452
 ENG. BUS. NO. 4846

Hill, Boring, & Dunn & Associates, Inc.
 CIVIL ENGINEERS / LAND PLANNERS

7950 BELFORT PARKWAY, SUITE 1600
 JACKSONVILLE, FLORIDA 32256
 904-281-1121

BRADY POINT PRESERVE

FOR:
 BRADY POINT PRESERVE, LLC
 NASSAU COUNTY, FLORIDA

GEOMETRY PLAN

FILE:
G-4
 DWG. NO.

SHEET 9 OF 40

NOT RELEASED FOR CONSTRUCTION

F:\2003-2004\WORKING\2805-04.dwg Thu Jun 10 09:06:53 2004 SMURRIN