

- LEGEND
- = UPLAND BUFFER/ CONSERVATION
 - = CONSERVATION
 - = WETLAND
 - = WETLAND IMPACT

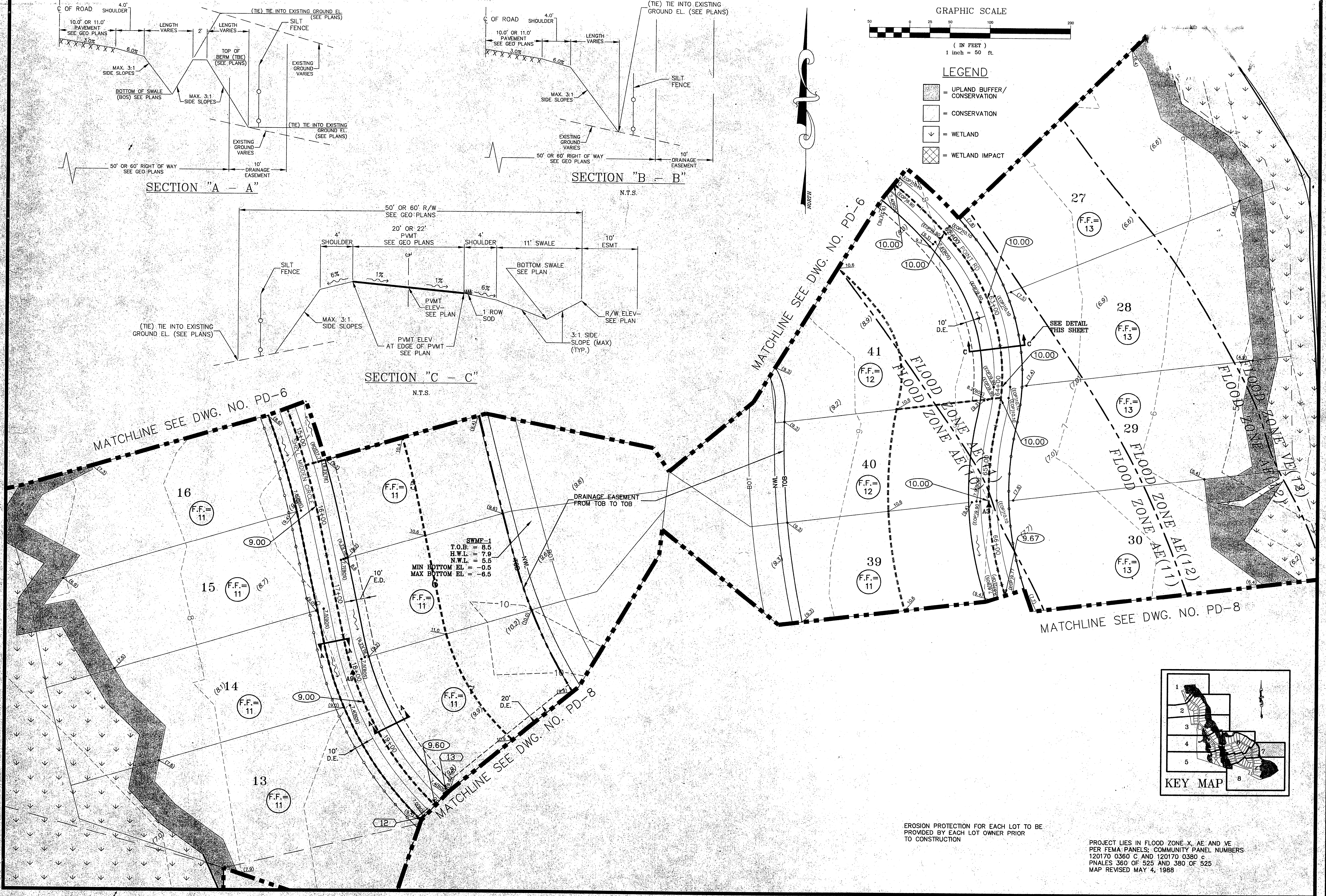

SWMP-1
T.O.B. = 8.5
H.W.L. = 7.9
N.W.L. = 5.5
MIN BOTTOM EL. = -0.5
MAX BOTTOM EL. = -8.5

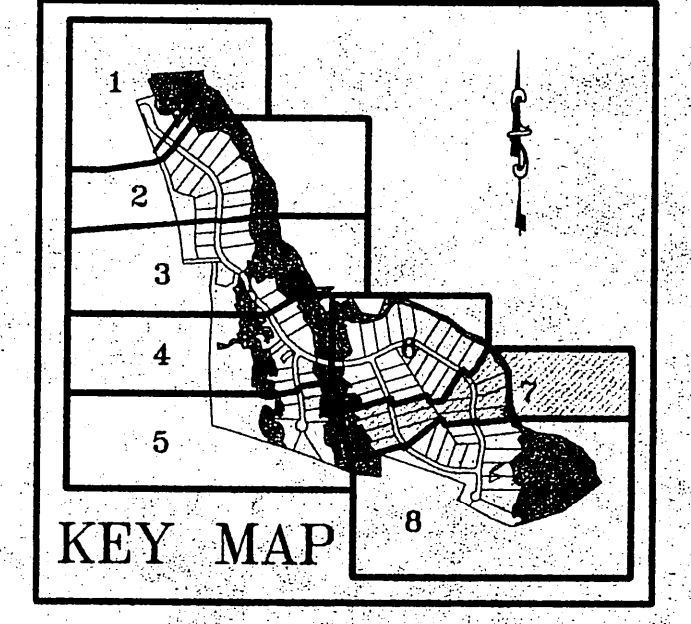

EROSION PROTECTION FOR EACH LOT TO BE PROVIDED BY EACH LOT OWNER PRIOR TO CONSTRUCTION

PROJECT LIES IN FLOOD ZONE X, AE AND VE PER FEMA PANELS; COMMUNITY PANEL NUMBERS 120170 0360 C AND 120170 0380 c PNALES 360 OF 525 AND 380 OF 525 MAP REVISED MAY 4, 1988

DESIGNED BY: PLB		Hill, Boring, Dunn & Associates, Inc. CIVIL ENGINEERS / LAND PLANNERS 7950 BELFORT PARKWAY, SUITE 1600 JACKSONVILLE, FLORIDA 32256 904-281-1121
DRAWN BY: SS, SM, AK		
CHECKED BY: VJD		
SCALE: 1" = 50'		
DATE: JULY, 2003		BRADY POINT PRESERVE FOR: BRADY POINT PRESERVE, LLC NASSAU COUNTY, FLORIDA PAVING AND DRAINAGE PLAN
PROJ. NO.: 0203-280		
NO.	DATE	DESCRIPTION
1	4/7/04	REVISED PER SURVAD COMMENTS
REVISIONS BY: VJC ENC. NO. 4846		
FILE: PD-7 DWG. NO. SHEET 20 OF 40		

NOT RELEASED FOR CONSTRUCTION