

NOTE:  
REFER TO PLAN G-1 FOR THE LEGAL DESCRIPTION.

NOTE:  
REFER TO PLAN G-7 FOR THE CENTERLINE LINE TABLES.

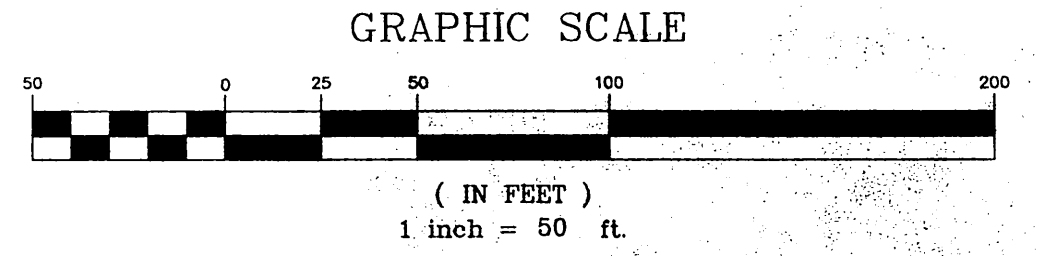

- LEGEND**
- = UPLAND BUFFER/ CONSERVATION
  - = CONSERVATION
  - = WETLAND
  - = WETLAND IMPACT

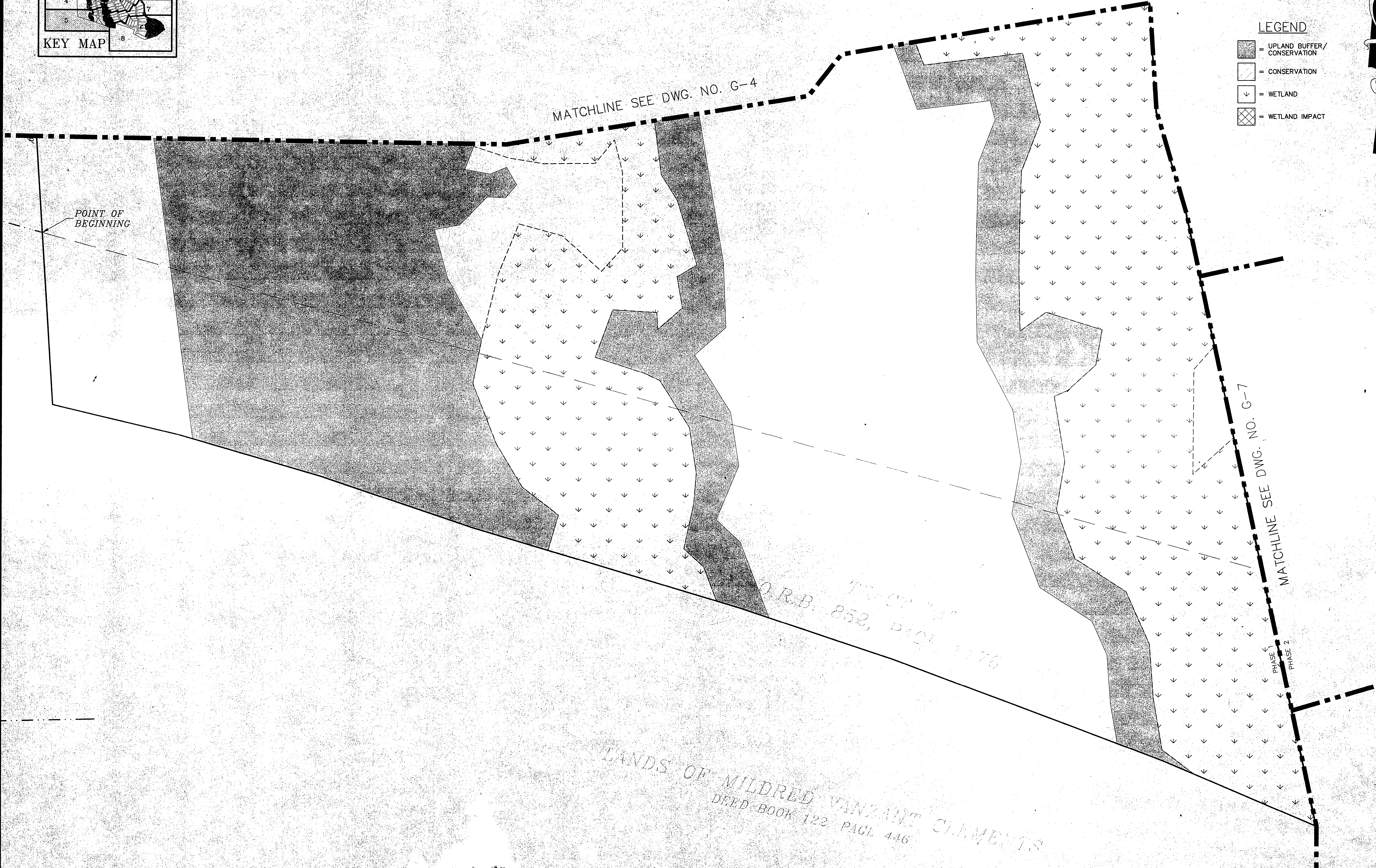
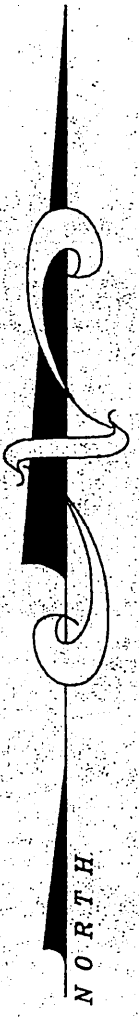

NO.	DATE	REVISIONS	DESCRIPTION	BY:

DESIGNED BY: PLB  
 DRAWN BY: SS, SM, AK  
 CHECKED BY: VJD  
 SCALE: 1" = 50'  
 DATE: JULY, 2003  
 PROJ. NO.: 0205-280

**Hill, Boring, & Associates, Inc.**  
 CIVIL ENGINEERS / LAND PLANNERS  
 7950 BELFORT PARKWAY, SUITE 1600  
 JACKSONVILLE, FLORIDA 32256  
 904-281-1121

**BRADY POINT PRESERVE**  
 FOR:  
 BRADY POINT PRESERVE, LLC  
 NASSAU COUNTY, FLORIDA  
 GEOMETRY PLAN

FILE:  
**G-5**  
 DWG. NO.  
 SHEET 10 OF 40